

Locus Plan

Exhibit 1

© 2019 - GZA GeoEnvironmental, Inc. \GZA\Bedford\Jobs\04.0190923\04.0190923.00 - Eversource_MSA\04.0190923.11 - L176 Fiber - Wetland Permitting\Figures\MXD\176 Fiber Crossing Wimpesaukee River.mxd, 8/5/2019, 12:47:21 PM, Lindsey White

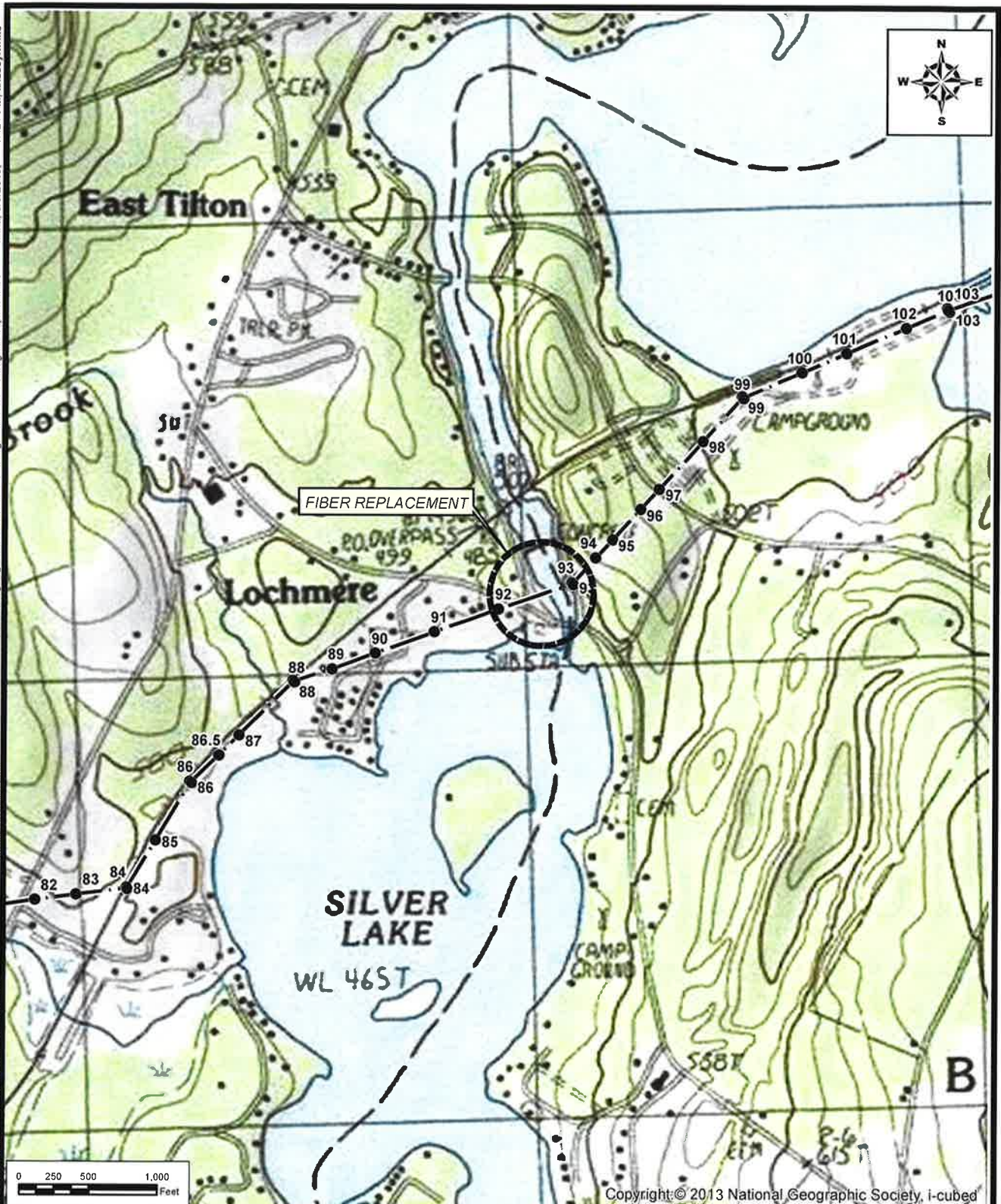

UNLESS SPECIFICALLY STATED BY WRITTEN AGREEMENT, THIS DRAWING IS THE SOLE PROPERTY OF GZA GEOENVIRONMENTAL, INC. (GZA). THE INFORMATION SHOWN ON THE DRAWING IS SOLELY FOR THE USE BY GZA'S CLIENT OR THE CLIENT'S DESIGNATED REPRESENTATIVE FOR THE SPECIFIC PROJECT AND LOCATION IDENTIFIED ON THE DRAWING. THE DRAWING SHALL NOT BE TRANSFERRED, REUSED, COPIED, OR ALTERED IN ANY MANNER FOR USE AT ANY OTHER LOCATION OR FOR ANY OTHER PURPOSE WITHOUT THE PRIOR WRITTEN CONSENT OF GZA. ANY TRANSFER, REUSE, OR MODIFICATION TO THE DRAWING BY THE CLIENT OR OTHERS, WITHOUT THE PRIOR WRITTEN EXPRESS CONSENT OF GZA, WILL BE AT THE USER'S SOLE RISK AND WITHOUT ANY RISK OR LIABILITY TO GZA.

L176 TRANSMISSION LINE FIBER REPLACEMENT PROJECT
 FRANKLIN, TILTON, BELMONT, & LACONIA,
 NEW HAMPSHIRE

PUBLIC UTILITIES COMMISSION
WINNIPESAUKEE RIVER CROSSING UPDATE
ORDER NO. 26,181, DOCKET DE 18-081

NO.	ISSUE / DESCRIPTION	BY	DATE

PREPARED BY: GZA GeoEnvironmental, Inc. Engineers and Scientists www.gza.com	PREPARED FOR: EVERSOURCE ENERGY		
PROJ MGR: TLT DESIGNED BY: LEW DATE: AUGUST 2019	REVIEWED BY: TLT DRAWN BY: LEW PROJECT NO: 04.0190923.11	CHECKED BY: DMZ SCALE: 1 in = 1,000 ft REVISION NO.	FIGURE 1

Copyright © 2013 National Geographic Society, i-cubed

Engineering Detail

Exhibit 2

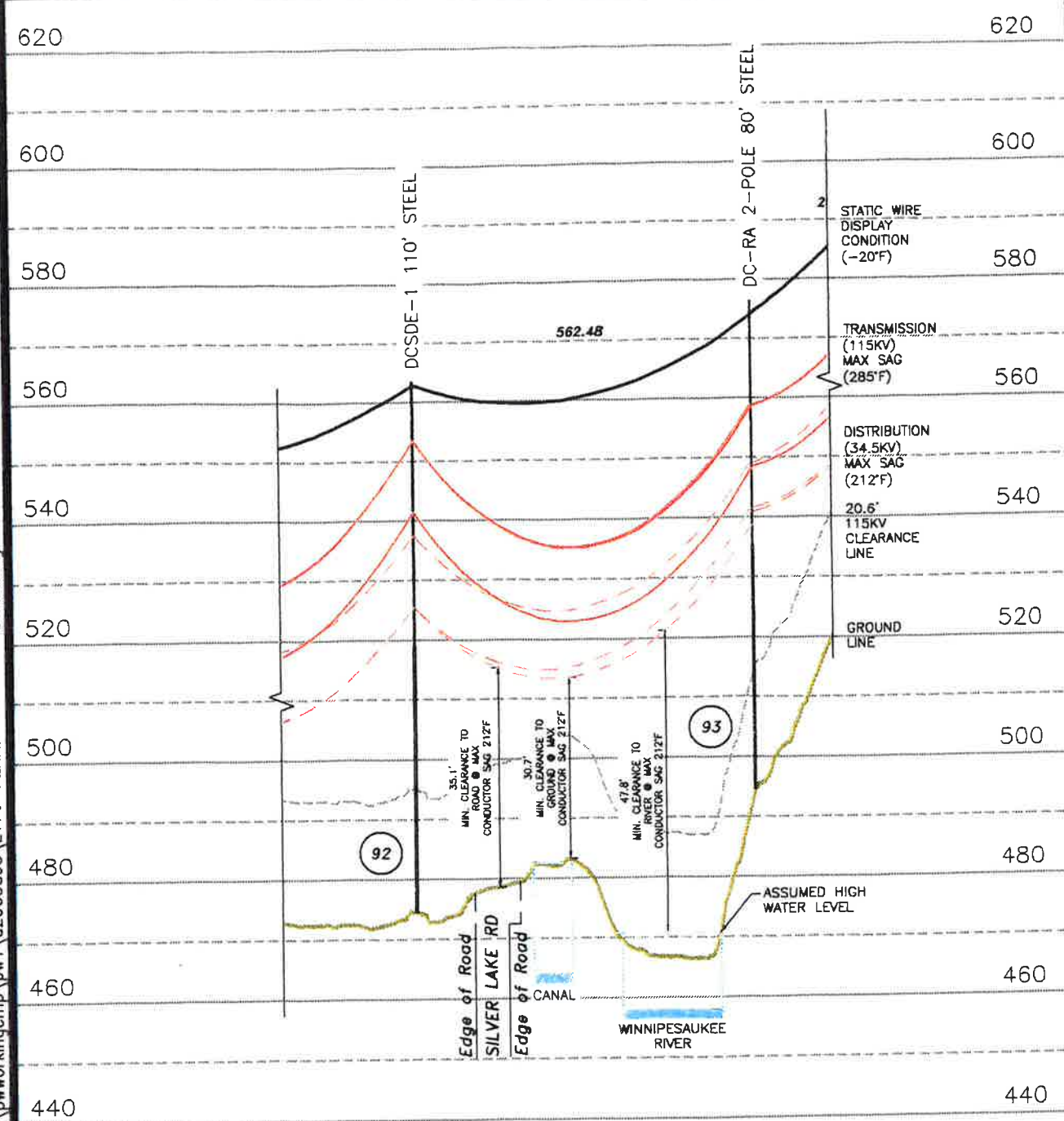

TOWN OF TILTON/BELMONT

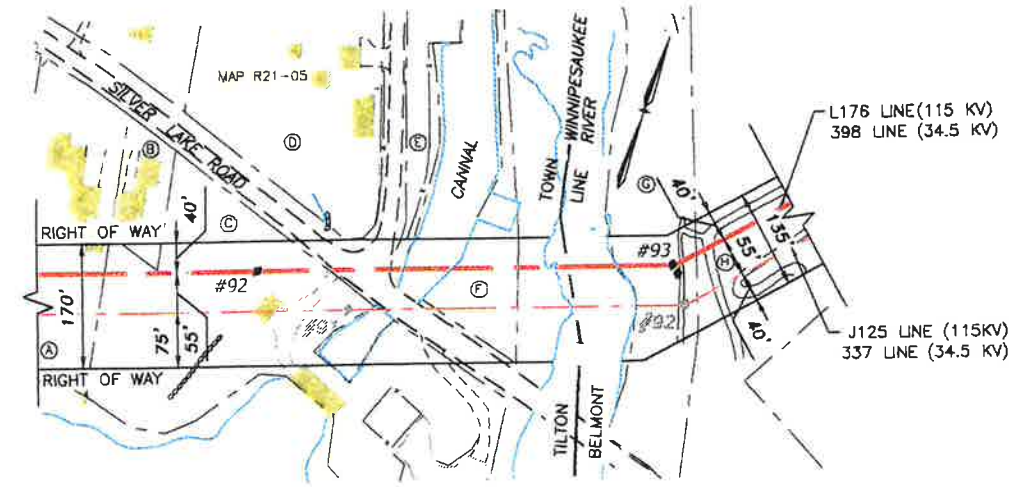
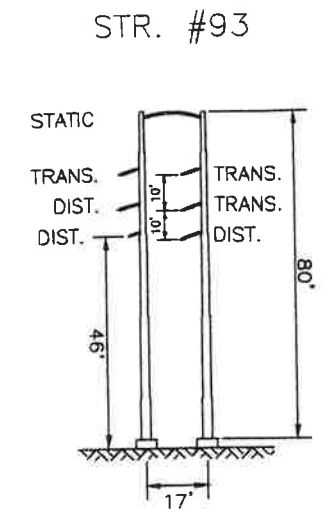
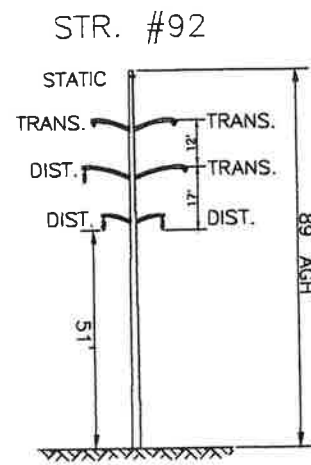

PROPERTY INFO LOCATION, MAP# AND PID#

- (A) MAP U03-02
- (B) MAP U03-01
- (C) MAP R21-07
- (D) MAP R21-05
- (E) MAP R21 UNK
- (F) MAP R21-06
- (G) MAP 117-005
- (H) MAP 117-006

- NOTES:
1. VERTICAL DATUM IS NAVD88 IN FEET.
 2. COORDINATE SYSTEM IS NEW HAMPSHIRE STATE PLANE NAD 83 US SURVEY FEET.
 3. MAP NUMBERS REFER TO TOWN OF TILTON/BELMONT TAX IDENTIFICATION MAP NUMBERS WITH CORRESPONDING PARCEL IDENTIFICATION NUMBERS.

STRUCTURE LOCATION:

STR. #92 - LAT.= 43°28'19.023"N
LONG.= 71°32'4.317"W

STR. #93 - LAT.= 43°28'20.847"N
LONG.= 71°31'57.111"W

CABLE SCHEDULE:

WIRE	# OF CABLES	TYPE	DIA. (IN.)	WEIGHT/1000 FT	CABLE STRENGTH (LBS.)
OPGW	1	0.646" OPGW (48F)	0.646	490.0	24,958
TRANSMISSION COND.	3	795 KCM 26/7 ACSR	1.108	1093.4	31,500
DISTRIBUTION COND.	3	477 KCM 26/7 ACSR	0.858	655.3	19,500

PROFILE LEGEND:

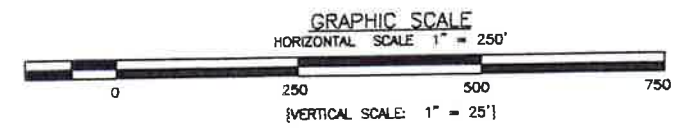

DWG REV	EPN/DESCRIPTION	CONT/PE#	DATE	DRN	CHKD	APPR
1	ISSUED FOR PERMIT		9/10/18	ORL	SAL	GEL
0.2	RE-ISSUED FOR PERMIT		4/18/18	NEB	BAF	GEL
0.1	RE-ISSUED FOR PERMIT		12/27/17	JJD	BAF	CRP
0	ISSUED FOR PERMIT		9/29/17	RDW	BAF	GEL

EVERSOURCE ENERGY

LINE L176 115KV TRANSMISSION & LINE 398 34.5KV DISTRIBUTION NHPUC WATER CROSSING PETITION WINNIPESAUKEE RIVER

SCALE: NTS
FILE: L176-PERMIT CRC
IMAGE:

T	1
DRAWN	JJD/TRC
ENGINEER	CRP/TRC
CHECKED	BAF/TRC
APPROVED	GEL/TRC
DATE	6/8/17
IG NO.	13901

Exhibit 2